

DE=	EN=	PT=	VN=
Metrisch/ Inch/ Psi/ LB/ Temp	Metric/ Inch/ Psi/ LB/ Temp		

**Metric / Inch/ PSI/ lb/ Galoes Liter/ Temp/ Info**

1 GAL= 3.78 Liter      1 lb = 0.4536 kg      1 PSI = 0.06895 bar  
 1 Liter= 0.264 Gal      1 kg = 2.2046 lb (pound)      1 bar (atü) = 14.50326 psi

**1 Inch: 1 Inch= 25.4 mm**

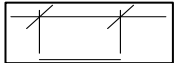

**1 Feet: 1 Feet= 12 Inch = 12 x 25.5 = 304.8 mm**

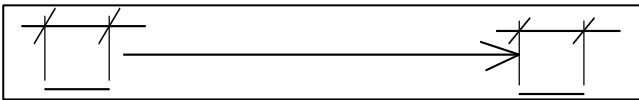

**1 Yard = 36 Inch= 36x 25.4 mm = 914.4mm ( or 0.914m)**



**1 Meile = 1760 Yard = 1.609344 Km or 5280 feet**

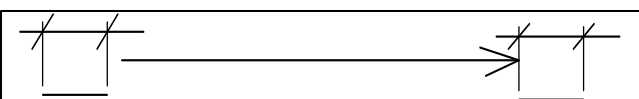

**1 mm = 1000my      1 mm = 1000my**

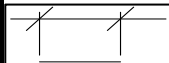

**1m= 1000mm (1 cm= 10 mm, 1 dm = 100mm)**

**1 m= 3 feet 3/8 inch**



**1 Km= 1000m**



**Temp. Referenz, Celsius 0 Grad /100 Grad**

Kelvin      Celsius      Fahrenheit

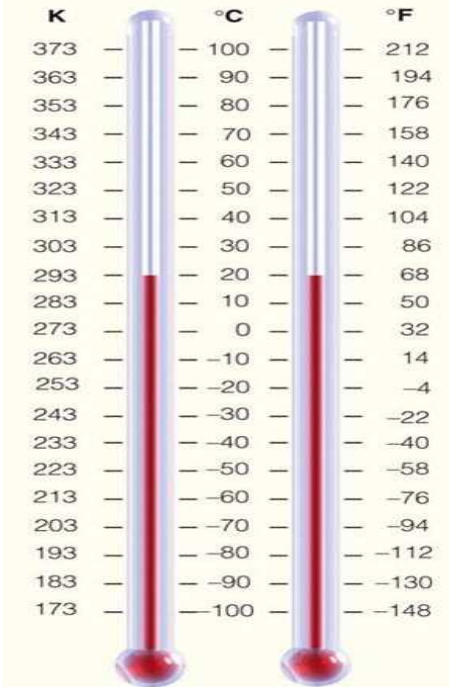

1 mm/2 = 1mm x 1mm

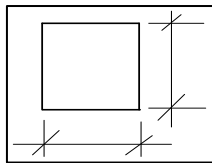

1 mm/2

1 m/2= 1m x 1 m

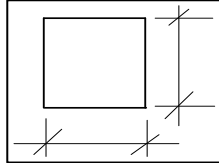

1 m/2

1 Ares = 10 x 10 Meter

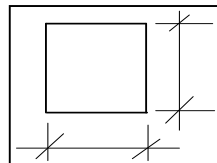

100 m/2

1 Hectares = 100 x 100 Meter

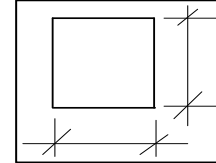

10000 m/2

1 km/2= 1000 x 1000 x m/2

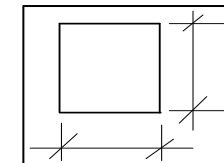

1'000'000 m/2

Nebeninfo: 1 Fussballfeld standard ist 68x105 M=0.714 Ha      Min. Fussballfeldgrösse 45 x 90 meter 0.45 Ha      Max Fussballfeld 90x120 Meter, 1.08 Ha

gezeichnet:	hpw	Datum:		education project	Metrisch/Inch/m3/Lb/psi/Temp	translate/en_ds/p_ct/vn_ro	origin: WIAP KFKOK
Aenderung:	an	Datum:	21.01.2015	WIAP KFKOK	Metric/Inch/m3/Lb/psi/Temp	r3a	datei_wi_8_f_1_0_19_a1_Metric_Inch_m3_Lb_psi_
Aenderung:	control 2	Data:		Safenwil Schweiz	spear 2	<a href="http://www.wiap.ch">www.wiap.ch</a>	idee of / from HPW