

DE =	EN =	PT =	VN =
Ölfeldfutter Flansch 1/2	Oilfield chuck flange 1/2		

**4 Jaw Independent, Extra Heavy Duty Chucks  
with Forged Steel Solid Body and Extra Large Thru-Hole**

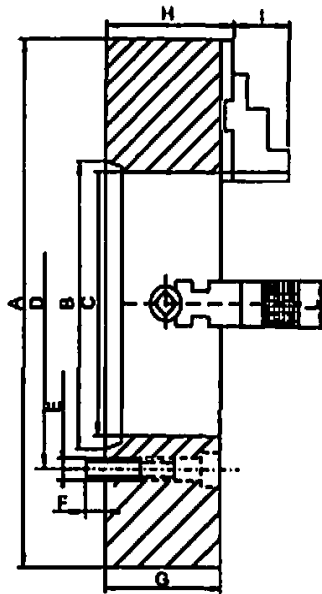

**Type A mount  
DIN 55026**

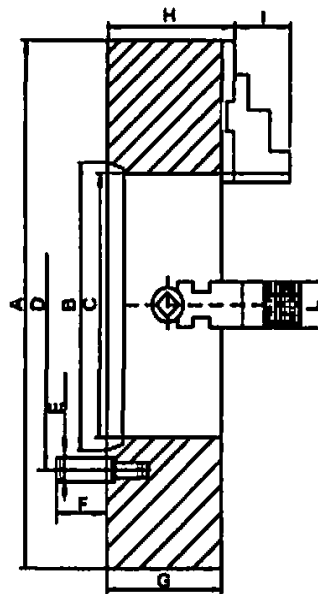

**Type D mount  
DIN 55029**

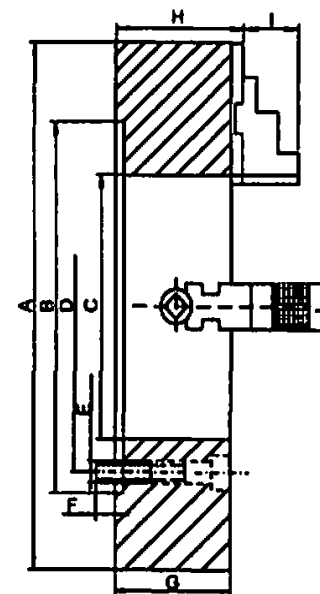

**Plain Back**

gezeichnet: hpw	Datum:		education project	Ölfeldfutter Flansch	translate/en_ds/p_ct/vn_ro	origin: Aus technischen Unterlagen
Aenderung: an	Datum:	29.04.2024	WIAP KFKOK	Oilfield chuck flange	r1	datei_wi_8_f_19_a2_Oelfeldfutter_Flans
Aenderung: control 2	Data:		Safenwil Schweiz	spear 2	<a href="http://www.wiapwidmers.info">www.wiapwidmers.info</a>	idee of / from HPW www.wiap.ch

DE =	EN =	PT =	VN =
Ölfeldfutter Flansch 2/2	Oilfield chuck flange 2/2		

**Direct Mount (A2) DIN 55026**

Chuck Dia. (A)	Taper No.	Thru-Hole (C)	B +0.01	D	G	H	I	K	L	N	E	F	Max. RPM	Weight lbs.
15-3/4*	A2-8	5.3(135)	5.50075	6.7500	5.71	6.067	2.981	.709	2.362	.748	M16x2	.961	1200	320
	A2-11	6.5(165)	7.75075	9.2500	5.71	6.067	2.981	.709	2.362	.748	M20x2.5	1.118	1200	302
20*	A2-11	6.5(165)	7.75075	9.2500	5.71	6.067	2.981	.866	2.362	.748	M20x2.5	1.118	1000	450
	A2-15	8.0(205)	11.251	13.000	5.71	6.067	2.981	.866	2.362	.748	M24x3	1.34	1000	425
25*	A2-15	10.5(267)	11.251	13.000	6.10	6.579	3.571	.866	2.953	.866	M24x3	1.34	850	685
	A2-20	12.55(320)	16.251	18.252	6.10	6.579	3.571	.866	2.953	.866	M24x3	1.50	850	662
28*	A2-15	10.5(267)	11.251	13.000	6.10	6.579	3.571	.866	2.953	.866	M24x3	1.34	750	915
	A2-20	12.55(320)	16.251	18.252	6.10	6.579	3.571	.866	2.953	.866	M24x3	1.50	750	873
32*	A2-15	10.5(267)	11.251	13.000	6.50	6.972	3.571	.866	2.953	.866	M24x3	1.34	600	1290
	A2-20	12.55(320)	16.251	18.252	6.50	6.972	3.571	.866	2.953	.866	M24x3	1.50	600	1248
40*	A2-20	14.5(368)	-	-	6.50	6.972	3.571	.866	2.953	.866	M24x3	-	600	-
	A2-28	20.86(530)	23.001	25.500	6.89	7.366	3.571	1.10	2.953	.866	M30x3.5	1.53	430	1687

**Direct Mount (Camlock D1) DIN 55029**

Chuck Dia. (A)	Taper No.	Thru-Hole (C)	B +0.01	D	G	H	I	K	L	N	E	F	Max. RPM	Weight lbs.
15-3/4*	D1-8	5.3(135)	5.50075	6.7500	5.71	6.067	2.981	.709	2.362	.748	1	2	1200	300
	D1-11	6.5(165)	7.75075	9.2500	5.71	6.067	2.981	.709	2.362	.748	1.25	2.4	1200	282
20*	D1-8	5.3(135)	5.50075	6.7500	5.71	6.067	2.981	.866	2.362	.748	1	2	1000	468
	D1-11	6.5(165)	7.75075	9.2500	5.71	6.067	2.981	.866	2.362	.748	1.25	2.4	1000	452
28*	D1-11	7.5(192)	7.75075	9.2500	6.10	6.579	3.570	.866	2.953	.866	1.25	2.4	750	993

**Plain Back**

Chuck Dia. (A)	Taper No.	Thru-Hole (C)	B +0.01	D	G	H	I	K	L	N	E	F	Max. RPM	Weight lbs.
40*	Plain Back	22.05(580)	28.5433	25.4691	6.89	7.366	3.571	1.10	2.953	.866	1-1/4*-7	1.53	430	1690

gezeichnet:	hpw	Datum:	29.04.2018	education project	Ölfeldfutter Flansch	translate/en_ds/p_ct/vn_ro	origin: aus techn. Unterlagen
Aenderung:	an	Datum:	29.04.2024	WIAP KFKOK	Oilfield chuck flange	r1	datei_wi_8_f_19_a2_Oelfeldfutter_Flans
Aenderung:	control 2	Data:	noch offen	Safenwil Schweiz	spear 2	<a href="http://www.wiapwidmers.info">www.wiapwidmers.info</a>	idee of / from HPW www.wiap.ch